

Installation Notes:

- Reverse the removal procedure.
- Insert the axle through the wheel hub and left fork leg.

Make sure that the lug (7) on the fork leg is located in the slot (8) in the brake panel.

- Tighten the axle.

Axle torque:

65 N·m (6.5 kg-m, 47 ft-lb)

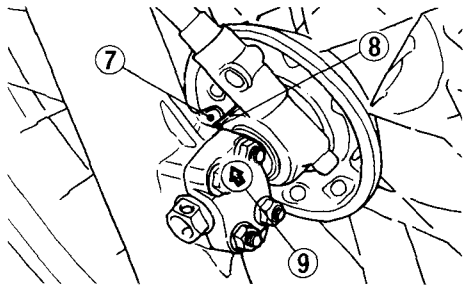

(7) Lug
(8) Slot

(9) UP mark

- Install the axle holder with the UP mark (9) upward and tighten the upper holder nuts to the specified torque first, then tighten the lower holder nuts to the same torque.

Axle holder nut torque:

12 N·m (1.2 kg-m, 9 ft-lb)

- Fit the caliper over the disc, taking care not to damage the brake pads. Install the caliper fixing bolts and tighten to a torque of:

25 N·m (2.5 kg-m, 19 ft-lb)

- After installing the wheel, apply the brake several times and check for free wheel rotation when released.

⚠ WARNING

- * **If a torque wrench was not used for installation, see your authorized Honda dealer as soon as possible to verify proper assembly. Improper assembly may lead to loss of braking capacity.**