

ENGINE OIL

Engine Oil Level Check

Check the engine oil level each day before riding the motorcycle.

The level must be maintained between the upper (1) and lower (2) level marks in the inspection window (3).

1. Start the engine and let it idle for a few minutes. Make sure the red information indicator and low oil pressure indicator goes off. If the light remains on, stop the engine immediately.
2. Stop the engine and hold the motorcycle in an upright position on firm, level ground.
3. After a few minutes, check that the oil level is between the upper (1) and lower (2) level marks in the inspection window (3).
4. If required, remove the oil filler cap (4) and add the specified oil (see page 79) up to the upper level mark. Do not overfill.

5. Reinstall the oil filler cap. Check for oil leaks.

CAUTION:

*** Running the engine with insufficient oil pressure may cause serious engine damage.**

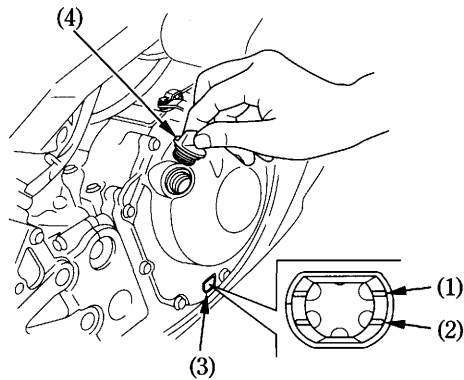

- (1) Upper level mark
- (2) Lower level mark
- (3) Inspection window

- (4) Filler cap