

E-4

CAMSHAFT/VALVE

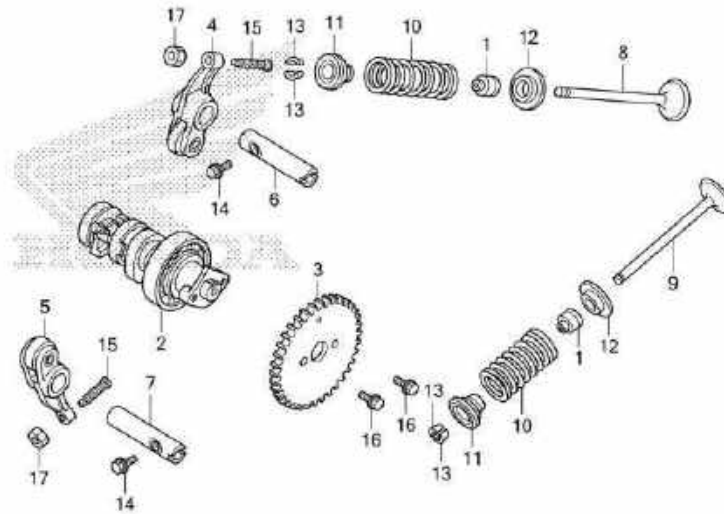

K939E0400

No. Ref.	L.O.N.	(Nomor ref. relatif) Deskripsi	F.R.T.
2	111118	CAMSHAFT	1,6
		.TERMASUK: Penyetelan klep	
3	111194	SPROCKET, CAM	0,7
4	1111K8	ARM, INTAKE VALVE ROCKER(SATU) ..	2,5
		.TERMASUK: Penyetelan klep	
		(7)	
5	1111K9	ARM, EXHAUST VALVE ROCKER(SATU) .	2,5
		.TERMASUK: Penyetelan klep	
		(7)	
	1111L8	ARM, VALVE ROCKER	
		:UNTUK 1 KENDARAAN	2,5
		.TERMASUK: Penyetelan klep	
8	1111ND	VALVE, INTAKE(SATU)	2,8
		.TERMASUK: Skir klep	
9	1111N1	VALVE, EXHAUST(SATU)	2,8
		.TERMASUK: Skir klep	
	1111P0	VALVE :UNTUK 1 KENDARAAN	3,0
		.TERMASUK: Skir klep	
		(1,11,12,13)	
10	1111P2	INTAKE VALVE SPRING DAN/ATAU	
		STEM SEAL(SATU)	2,6
	1111P3	EXHAUST VALVE SPRING DAN/ATAU	
		STEM SEAL(SATU)	2,6
	1111Q2	VALVE SPRING DAN/ATAU STEM SEAL	
		:UNTUK 1 KENDARAAN	2,7

No. Ref.	No. Part	Deskripsi	Jumlah SC00FY (SP/ACF110) CBS ISS (CBT) 2017(in) 2018(j)	No. Seri	Kode Parts Catalog
1	12209-GB4-681	SEAL, VALVE STEM(NO)	2	2	
	12209-GB4-682	SEAL, VALVE STEM(AR)	2	2	
2	14100-K50-T00	CAMSHAFT COMP.	1	1	
3	14321-KZL-E00	SPROCKET, CAM(34T)	1	1	
4	14430-K93-N00	ARM COMP., IN. VALVE ROCKER	1	1	
5	14440-K93-N00	ARM COMP., EX. VALVE ROCKER	1	1	
6	14451-KYY-900	SHAFT, IN. ROCKER ARM	1	1	
7	14452-KYY-900	SHAFT, EX. ROCKER ARM	1	1	
8	14711-K81-N00	VALVE, IN.	1	1	
9	14721-K81-N00	VALVE, EX.	1	1	
10	14751-KWP-900	SPRING, VALVE	2	2	
11	14771-K93-N00	RETAINER, VALVE SPRING	2	2	
12	14775-KVY-900	SEAT, VALVE SPRING	2	2	
13	14781-MA6-000	COTTER, VALVE	4	4	
14	90002-KWB-600	BOLT, FLANGE, 5X12	2	2	
15	90012-KWW-740	SCREW, TAPPET ADJUSTING	2	2	
16	90083-GB6-911	BOLT, KNOCK, 5MM	2	2	
17	90206-001-000	NUT, TAPPET ADJUSTING	2	2	

2