

# F-41

# WIRE HARNESS

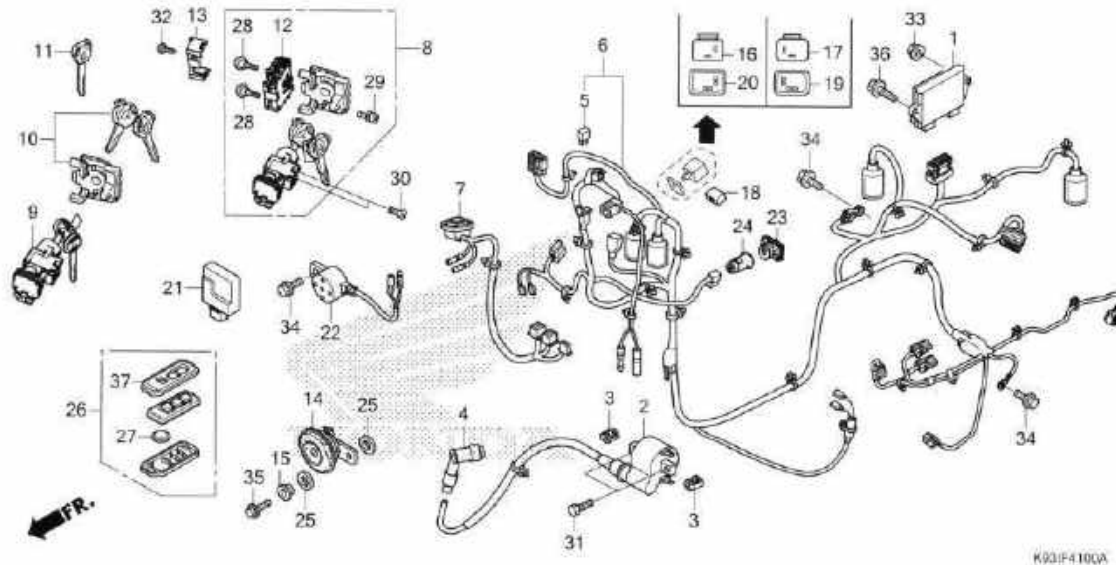

| No. Ref. | No. Part       | Deskripsi                            | Jumlah   | No. Seri | Kode Parts Catalog |
|----------|----------------|--------------------------------------|--|----------|--------------------|
|          |                |                                      | SCOOPI-SP (ACF110)<br>CBS-ISS (CBT)<br>2017(H) 2016(L) |          |                    |
| 21       | 38410-K93-N01  | CONTROL UNIT, ALARM & ANSWER<br>BACK | 1  | 1        |                    |
| 22       | 38720-K66-V11  | BUZZER ASSY. ....                    | 1  | 1        |                    |
| 23       | 39602-K41-N21  | CAP ASSY. ....                       | 1  | 1        |                    |
| 24       | 39624-K41-N21  | SOCKET ASSY. ....                    | 1  | 1        |                    |
| 25       | 61106-KW6-840  | RUBBER B, MOUNTING ....              | 2  | 2        |                    |
| 26       | 72147-K93-N02  | TRANSMITTER ASSY., ALARM &<br>ANSWER | 1  | 1        |                    |
| 27       | 72148-TY0-000  | BATTERY COMP. (CR1632) ....          | 1  | 1        |                    |
| 28       | 90101-MT4-000  | SCREW, SCREEN SETTING ....           | 2  | 2        |                    |
| 29       | 90111-MR5-000  | BOLT, SOCKET, 5X9 ....               | 1  | 1        |                    |
| 30       | 90164-KZL-A00  | SCREW, U-LOCK FLAT, 6X12 ....        | 2  | 2        |                    |
| 31       | 92101-06020-4J | BOLT, HEX., 6X20 ....                | 2  | 2        |                    |
| 32       | 93901-24320    | SCREW, TAPPING, 4X12 ....            | 1  | 1        |                    |
| 33       | 94050-06000    | NUT, FLANGE, 6MM ....                | 1  | 1        |                    |
| 34       | 95701-06012-00 | BOLT, FLANGE, 6X12 ....              | 3  | 3        |                    |
| 35       | 95701-06016-00 | BOLT, FLANGE, 6X16 ....              | 1  | 1        |                    |
| 36       | 95701-06020-00 | BOLT, FLANGE, 6X20 ....              | 1  | 1        |                    |
| 37       | 72146-K93-N01  | CASE, UPPER ....                     | 1  | 1        |                    |