

F-12 Exhaust muffler

J 13

F-12 Exhaust muffler

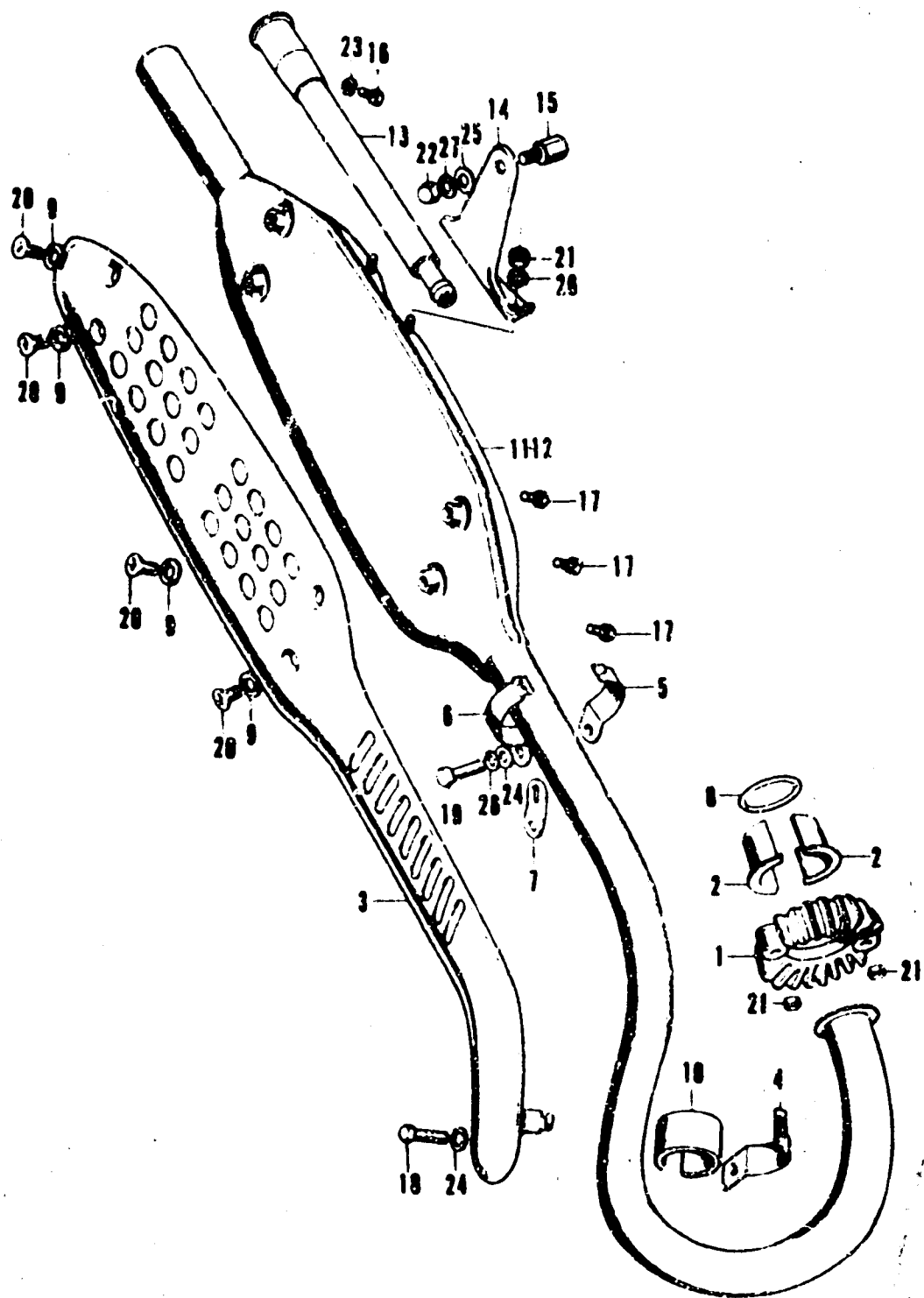

Ref. No.	Part No.	Description	Reqd. No.		Serial No.
			CL	CL	
1	18231-323-000	JOINT, EX. PIPE	1	1	
2	16233-107-000	COLLAR, EX. PIPE JOINT	2	2	
3	18257-108-760	PROTECTOR, EX. MUFFLER	1	1	
4	18272-108-770	BAND, PROTECTOR SETTING	1	1	
5	18281-108-760	BAND A, EX. PIPE	1	1	
6	18282-108-760	BAND B, EX. PIPE	1	1	
7	18284-108-770	STAY, EX. PIPE	1	1	
8	18291-216-000	GASKET, EX. PIPE	1	1	
9	18292-254-000	GASKET, PROTECTOR	4	4	
10	18293-108-000	PACKING, PROTECTOR BAND	1	1	
11	18300-359-671	MUFFLER COMP., EX.	1	1	
	18300-359-672	MUFFLER COMP., EX. 18300-359-673	1	1	1107467
12	18300-359-673	MUFFLER COMP., EX.	1	1	1107468
13	18311-359-670	PIPE A, EX. DIFFUSER 18311-359-671	1	1	
	18311-359-671	PIPE, DIFFUSER	1	1	
14	18353-108-7600	BRACKET, MUFFLER	1	1	
15	90120-056-010	BOLT, RR. MUFFLER SETTING	1	1	
16	92000-05018-4J	BOLT, HEX., 5X8	1	1	
17	92000-06008	BOLT, HEX., 6X8	3	3	1107468
18	92000-06016	BOLT, HEX., 6X16	1	1	
19	92000-06020	BOLT, HEX., 6X20	1	1	
20	93700-06008-19	SCREW, OVAL, 6X8	4	4	
21	94001-06000	NUT, HEX., 6MM	4	4	
22	94021-09020-05	NUT, CAP, 9MM	1	1	
23	94101-05000	WASHER, PLAIN, 5MM	1	1	
24	94101-06000	WASHER, PLAIN, 6MM	2	2	
25	94101-08000	WASHER, PLAIN, 8MM	1	1	
26	94111-06000	WASHER, SPRING, 6MM	3	3	
27	94111-08000	WASHER, SPRING, 8MM	1	1	