

## E-8A OIL PUMP

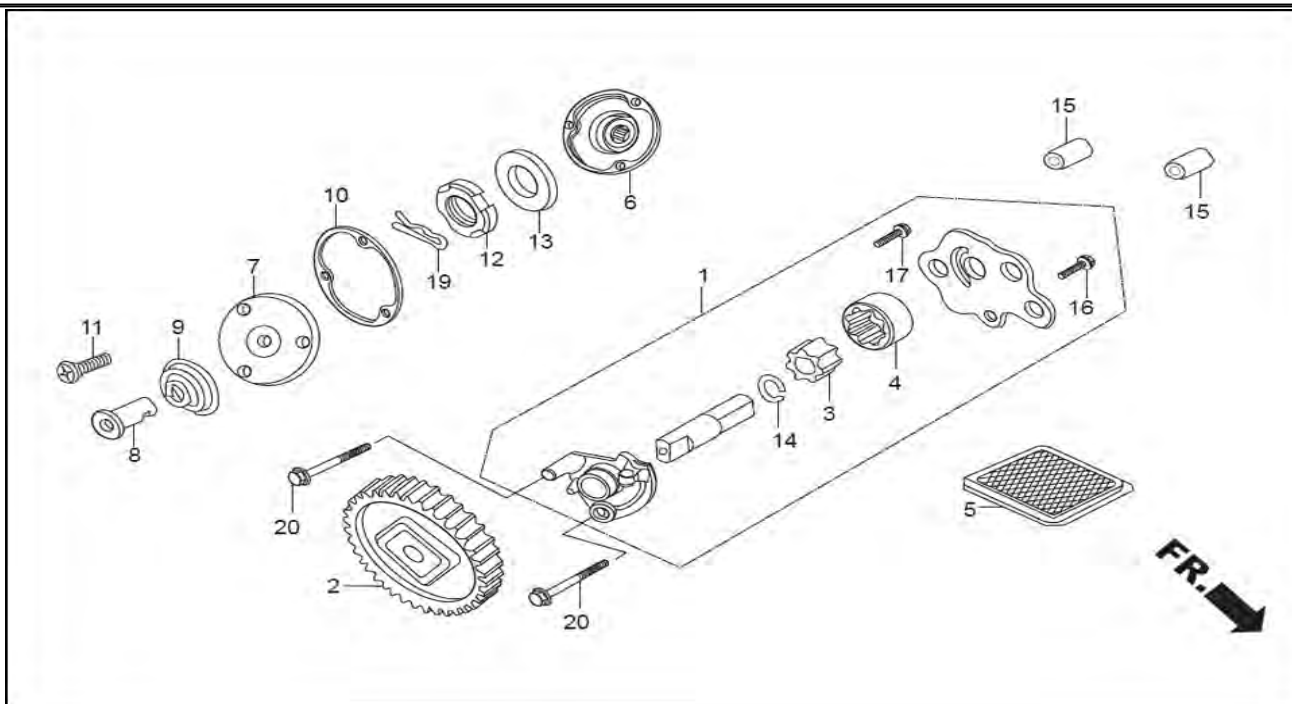

Service Item	F.R.T.	Group Number: E-8A Model :: Ignitor (May, 2012)			
		Ref No.	Part Number	Description	Req.
* CAP, OIL FILTER ROTOR	0.6	1	15100-K06-600	OIL PUMP ASSY	1
* GEAR COMP., OIL PUMP DRIVE	--	2	15130-KRM-840	GEAR COMP., OIL PUMP	1
* SCREEN, OIL FILTER	--	5	15421-KTN-900	SCREEN, OIL FILTER	1
* PUMP ASSY., OIL	0.7	6	15430-KSP-910	ROTOR, OIL FILTER	1
* ROTOR, OIL PUMP INNER	--	7	15436-KRM-840	CAP, OIL FILTER ROTOR	1
(SAME TIME FOR TWO UNITS)	--	8	15441-KCS-650	OIL, THROUGH	1
		9	15446-107-000	SPRING, OIL THROUGH	1
		10	15459-KWK-900	GASKET ,OIL FILTER CAP	1
		11	90191-KPH-970	SCREW OVAL 6X65	1
		12	90231-KM7-700	NUT, LOCK, 14 MM	1
		13	90432-KPT-A00	WASHER, 14.2 X 26 X 3	1
		16	93700-05012-0A	SCREW, OVAL, 5X12	3
		17	93901-34120	SCREW, TAPPING, 4X8	1
		18	93913-14280	SCREW TAPPING 4X12	1
		19	94251-08000	PIN LOCK, 8 MM	1
		20	95701-06035-00	BOLT, FLANGE, 6X35	2