

Never reuse the old drive chain, master link, master link plate and O-rings.  
Assemble the new master link, O-rings and plate.

Assemble and set the drive chain tool set.

**TOOL:**

Drive chain tool set

07HMH-MR10103

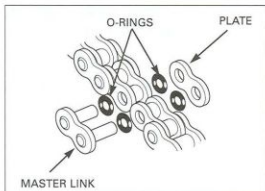

*Insert the master link from the inside of the drive chain, and install the plate with the identification mark facing the outside.*

Make sure that the master link pins are installed properly.  
Measure the master link pin length projected from the plate.

**STANDARD LENGTH:**

DID: 1.15 – 1.55 mm (0.045 – 0.061 in)

RK: 1.2 – 1.4 mm (0.05 – 0.06 in)

Stake the master link pins.

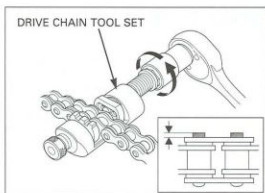

*A drive chain with a clip-type master link must not be used.*

Make sure that the pins are staked properly by measuring the diameter of the staked area using a slide caliper.

**DIAMETER OF THE STAKED AREA:**

DID: 5.50 – 5.80 mm (0.217 – 0.228 in)

RK: 5.55 – 5.85 mm (0.219 – 0.230 in)

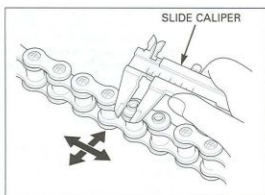

After staking, check the staked area of the master link for cracks.

If there is any cracking, replace the master link, O-rings and plate.

